



Setup Guide

VALVE INDEX VR KIT

Welcome to Virtual Reality.

Valve Index is your access to the wondrous people, places, and things you'll interact with in the virtual worlds. While the Valve Index is infinite, thankfully its setup is not.

Let's get started!

1 Install SteamVR

Before setup, be sure your operating system and video drivers are up to date.

Download SteamVR from the website below and install it on your VR Ready PC.

Create or log into your Steam account before proceeding.



steamvr.steampowered.com



Read the enclosed safety information to reduce the risk of accidents such as tripping, falling, entanglement, collisions, or electrical and fire hazards.

2 Prepare your play area

For Room Scale VR, you will need at least 2m x 1.5m (6.5ft x 5ft) of free space. Standing-only or seated setups can be achieved in smaller spaces.

Choose a play area that gives you enough room that your outstretched arms, including controllers, will not touch walls, ceiling, or objects around you.

Be sure there is nothing dangerous in or around your play area, such as pets, stairs, or windows.

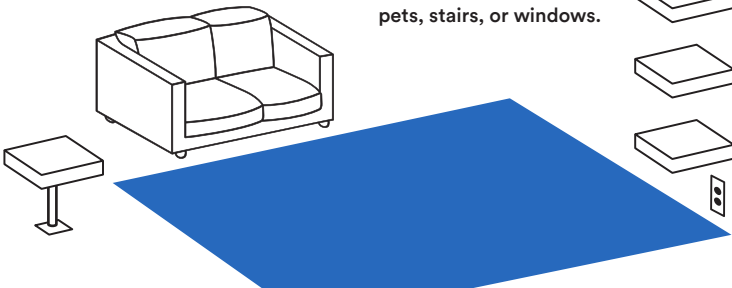
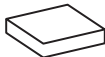

3 Attach your base station stands

For now, screw each stand onto the bottom of a base station.

Later, as a more permanent solution, you may choose to use these same stands as wall mounts. Visit our website for detailed wall-mounting instructions.

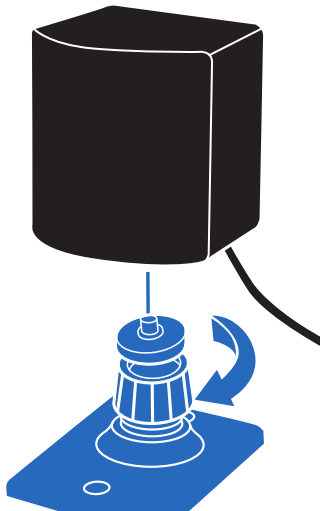



4 Plug in & place your base stations

Place your base stations at opposite corners of your play area, pointing toward its center. In general, higher up is better, though be sure to select a stable surface when placing them.

Plug each base station into an outlet and remove its protective film.

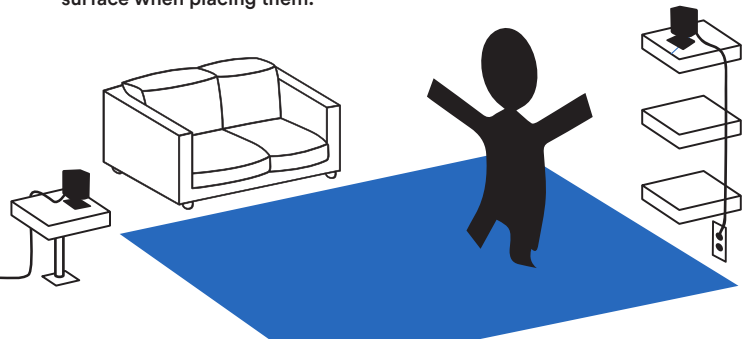



5 Connect your headset

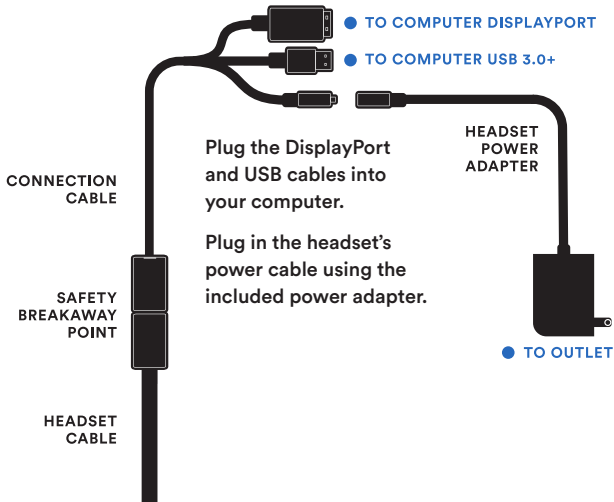



6 Turn on your controllers

Turn on your controllers using the System button. This launches SteamVR. Controllers will automatically pair with your headset, as indicated by their green lights.

Note: Your controllers are partially charged for a few hours of playtime. To charge them, use the provided USB cables.

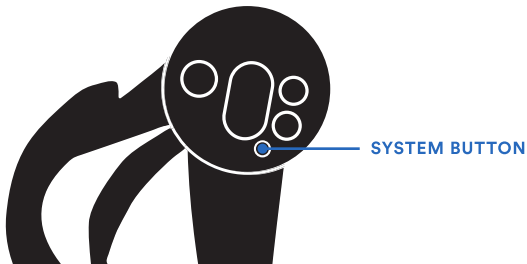

7 Enjoy VR!

Follow the on-screen instructions to complete setup and enjoy VR.



To launch SteamVR next time, click the VR button in the upper corner of Steam.



**Fine tuning for
fit & comfort**

Wearing your controllers

For added security, attach the lanyards to your controller grips. Adjust each lanyard to secure the controller at your wrist.

Grip the controller and using your other hand, pull the adjustment strap snug. To loosen it, press the release button.

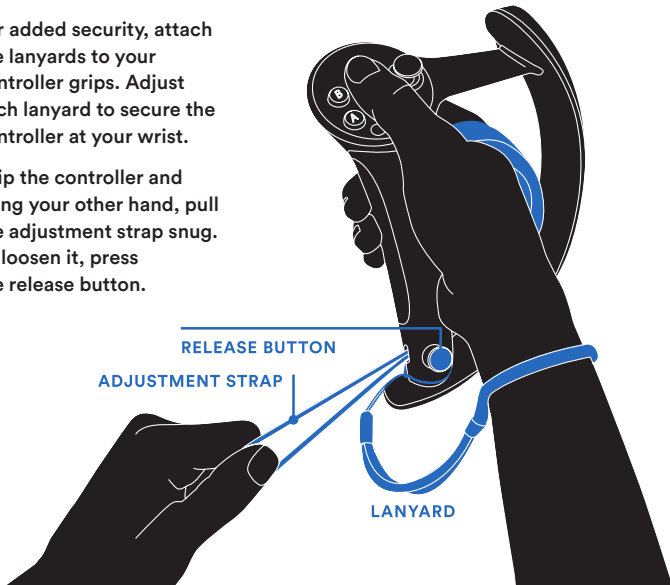

Adjusting your controllers for fit

To adjust for different hand sizes, push in the size adjustment arm, then swing it left or right.

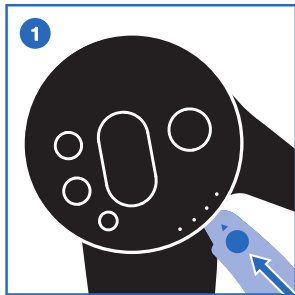

Push inward.

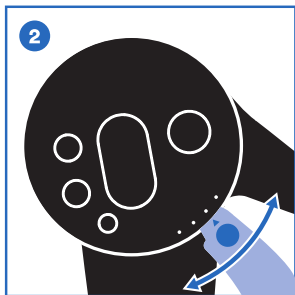

Larger hands? Swing down.
Smaller hands? Swing up.

Adjusting your headset for fit

To adjust your headset, twist the rear headstrap adjustment knob for a snug fit, then tighten the top strap.

If your headset still feels loose, add the rear cradle adapter to the back.

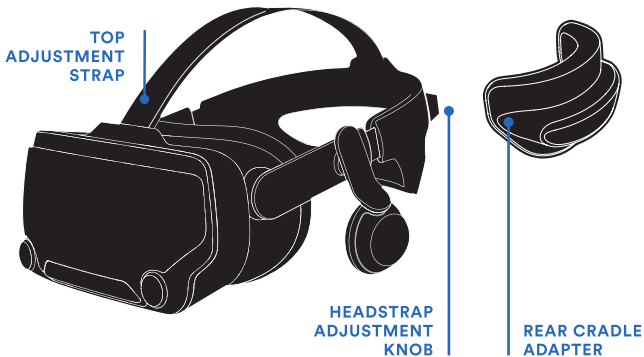

Fine-tuning image clarity

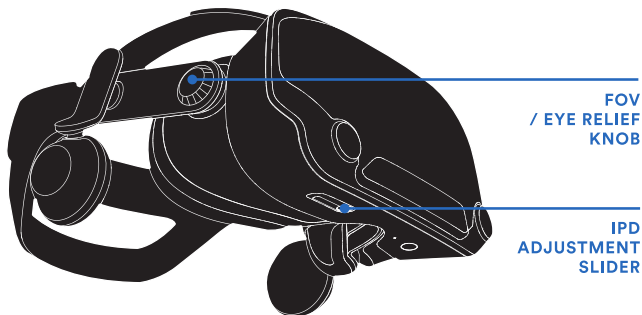

To optimize image clarity, move the IPD adjustment slider while wearing the headset. This moves the lenses to match the distance between your eyes.

To maximize field of view, push in and twist the FOV / eye relief knob. Position displays as close to eyes or glasses as is comfortable.

Positioning audio

To position audio earpieces, pivot and slide each until it is centered and hovers over your ear.

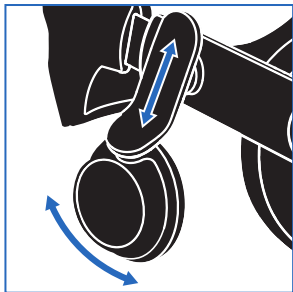

Hovers away from ear!



For additional setup and safety information,
visit our website.

steamvr.steampowered.com



V003715-00